

LEGEND

- SITE BOUNDARY LINE
- EXTERNAL BOUNDARY LINE
- KD KERB ONLY
- VC VEHICLE CROSSING
- PROPOSED SPOT HEIGHT
- EXISTING SPOT HEIGHT
- TW XX.XX TOP OF WALL HEIGHT
- BW XX.XX BOTTOM OF WALL HEIGHT
- FALL DIRECTION OF GRADE
- PROPOSED FINISHED FLOOR LEVEL
- EXISTING CONTOURS (0.1m INTERVALS)
- PROPOSED BUILDING EXTENTS
- NON-Trafficable PAVERS - REFER TO PAVEMENT PLAN FOR TYPES AND DETAILS (TO BE CONFIRMED)
- VEHICLE CROSSOVER - REFER TO DETAILS
- ELEVATED PATHWAY - REFER TO LANDSCAPE ARCHITECT'S DRAWINGS FOR DETAILS
- STRUCTURAL SLAB - REFER TO STRUCTURAL DRAWINGS FOR DETAILS
- LANDSCAPING - REFER TO LANDSCAPE ARCHITECT'S DRAWINGS FOR DETAILS
- ROAD PAVEMENT REINSTATEMENT
- SAWCUT AND PAVEMENT INFILL
- RETAINING WALL
- BLOCKWORK WALL
- DOWNTURN EDGE BEAM
- SEATING EDGE
- PROPOSED RIDGE IN PAVEMENT
- STORMWATER NETWORK - REFER TO C06.01 FOR DETAILED STORMWATER LAYOUT
- EXISTING ELECTRICITY
- EXISTING TELECOMMUNICATIONS
- EXISTING SEWER
- EXISTING GAS

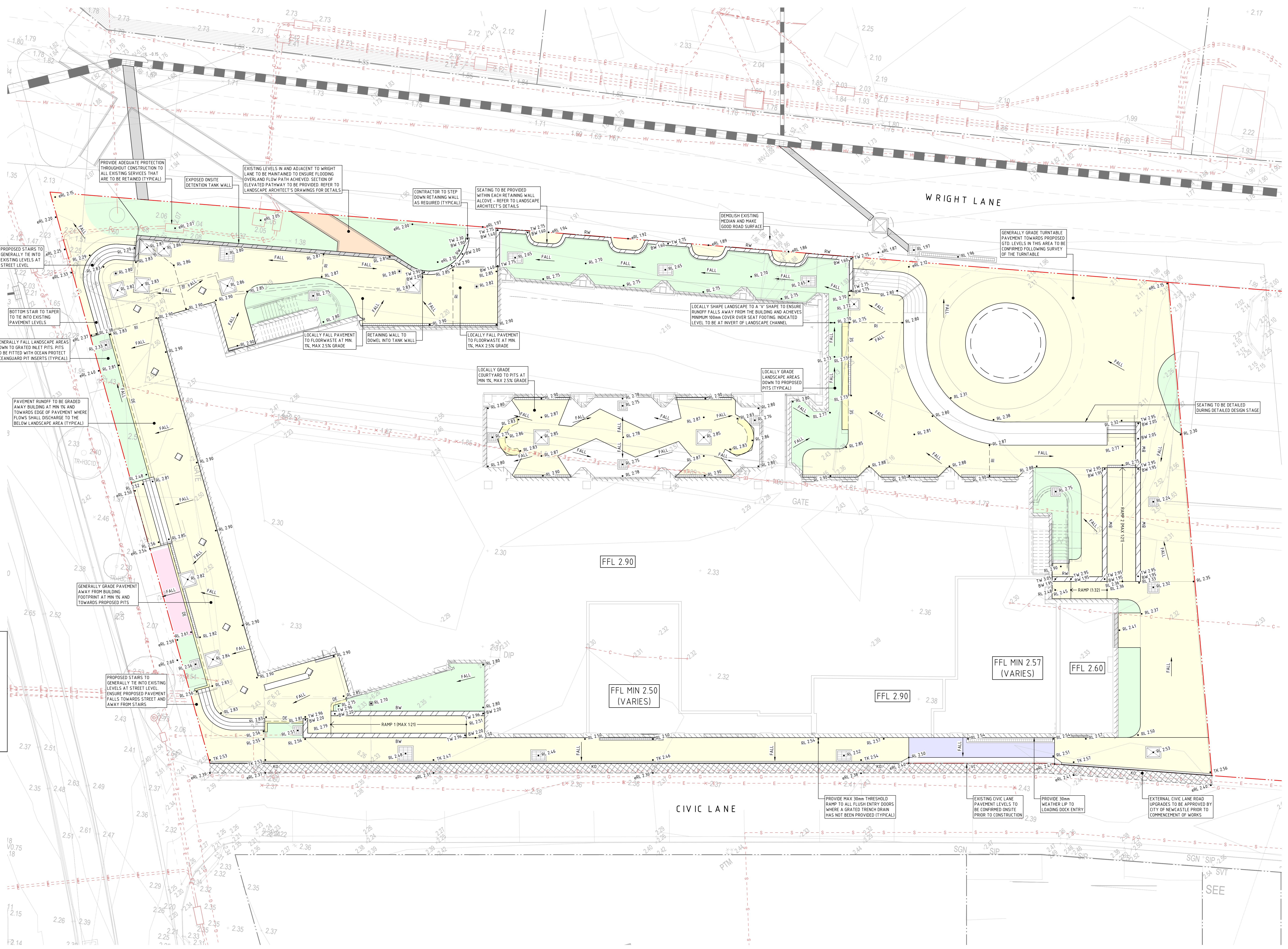

Department of Planning, Housing and Infrastructure
 Issued under the Environmental Planning and Assessment Act 1979
 Approved Section 4.55 (1A) Modification Application
 Approved Application No: SSD 61618229 Mod 1
 Approved on: 27 February 2026
 Signed: AW Sheet No: 2 of 4

DRAWN: D. MAROUDIS, DESIGNED: E. GEARING, CHECKED: K. SINGLAR, VERIFIED: K. SINGLAR, JOB MANAGER: K. SINGLAR

REVISION	DESCRIPTION	ISSUED	VER'D	APP'D	DATE
A	ISSUED FOR SSDA APPROVAL	DM	EG		10.10.25

CLIENT THE UNIVERSITY OF NEWCASTLE AUSTRALIA	ARCHITECT architectus	PROJECT NORTHROP Newcastle Level 1, 215 Pacific Hwy, Charlestown NSW 2290 Ph (02) 4943 1777 Email newcastle@northrop.com.au ABN 81 094 433 100	PROJECT THE UNIVERSITY OF NEWCASTLE CITY CAMPUS STUDENT ACCOMMODATION 20 CIVIC LANE NEWCASTLE NSW 2300	DRAWING TITLE CIVIL WORKS PLAN	DRAWING SHEET SIZE = A0
DRAWING NOT TO BE USED FOR CONSTRUCTION UNLESS VERIFICATION SIGNATURE HAS BEEN ADDED		THE COPYRIGHT OF THIS DRAWING REMAINS WITH NORTHROP CONSULTING ENGINEERS PTY LTD	SCALE 1:100 @ A0	JOB NUMBER 242432	REVISION A
			DRAWING NUMBER DA-C04.01		

NOT FOR CONSTRUCTION

LEGEND

- SITE BOUNDARY LINE
- EXTERNAL BOUNDARY LINE
- PROPOSED STORMWATER PIPE
- INDICATIVE HYDRAULIC STORMWATER PIPE
- EXISTING STORMWATER PIPE
- EXISTING KERB INLET PIT
- STORMWATER PIT AND TAG COVER LEVEL
- HY PIT CL XX.XX
- HYDRAULIC STORMWATER PIT AND TAG COVER LEVEL
- TANK ACCESS CHAMBER AND TAG COVER LEVEL
- AC CL XX.XX
- REFER OSD DETAILS
- PROPRIETARY GRATED TRENCH DRAIN AT BUILDING ACCESS
- MIN 150mm WIDE CLEAR OPENING WITH HELPROOF GRATE CLASS 'B' (U.N.O.)
- GT01
- PROPRIETARY GRATED TRENCH DRAIN IN PAVEMENT
- MIN 150mm WIDE CLEAR OPENING WITH HELPROOF GRATE CLASS 'B' (U.N.O.)
- GT02
- ON-SITE DETENTION TANK WITH WATER QUALITY CHAMBERS
- OSD
- PROPRIETARY RAINWATER OUTLET WITH HELPROOF GRATE (MIN Ø150mm)
- RWO
- SUBSOIL DRAINAGE CLEAROUT
- CO
- SUBSOIL DRAINAGE
- FFL XX.XX
- PROPOSED FINISHED FLOOR LEVEL
- REFER TO C04-01

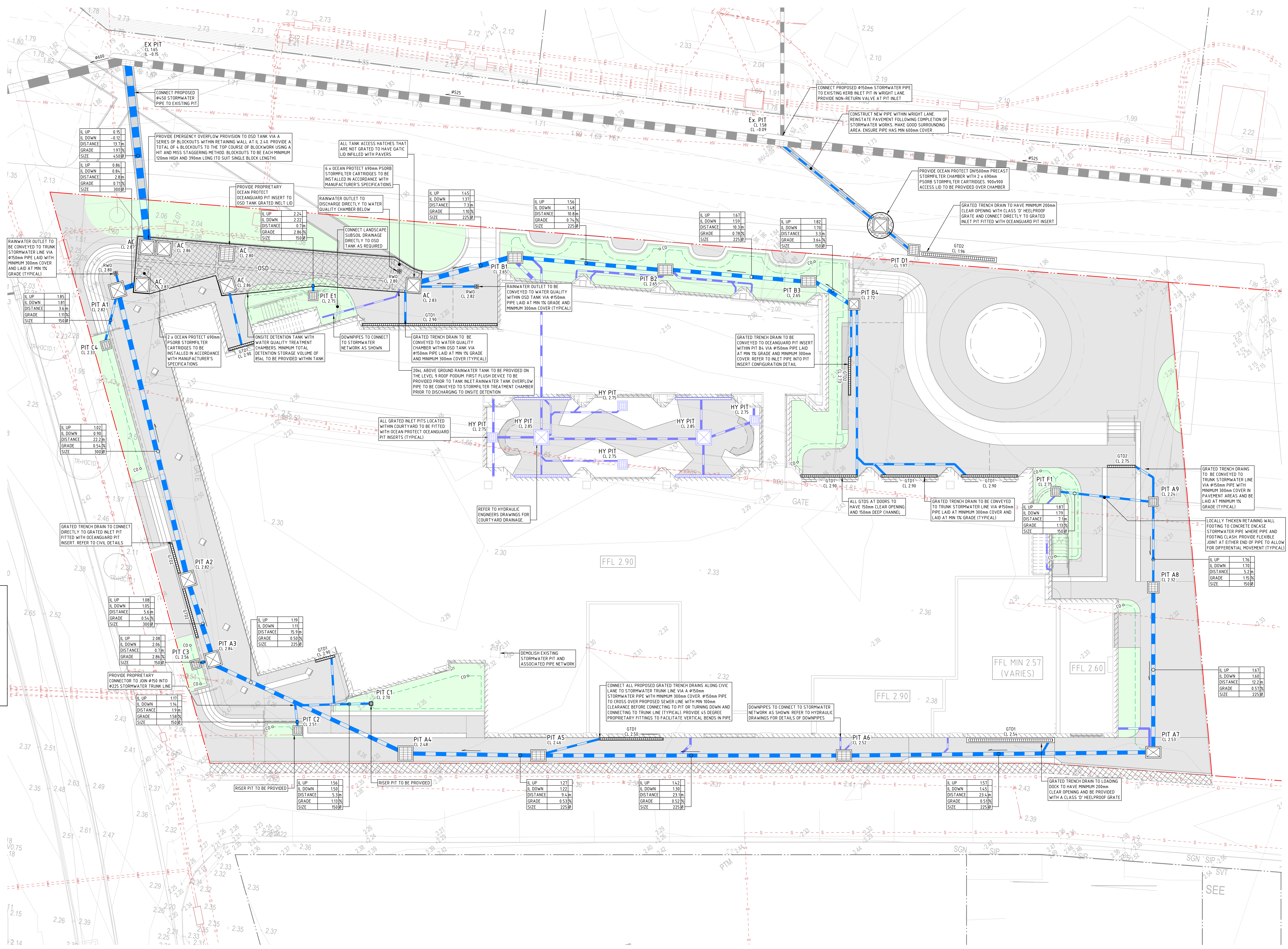

Department of Planning, Housing and Infrastructure
NSW GOVERNMENT

Issued under the Environmental Planning and Assessment Act 1979

Approved Section 4.55 (1A) Modification Application

Approved Application No: SSD 61618229 Mod 1

Approved on: 27 February 2026

Signed: AW Sheet No: 3 of 4

DRAWN: D. MAROUDIS, DESIGNED: E. GEARING, JOB MANAGER: K. SINGLAR, CHECKER: K. SINGLAR

REVISION	DESCRIPTION	ISSUED	VER'D	APP'D	DATE
A	ISSUED FOR SSDA APPROVAL	DM		EG	10.10.25

CLIENT: THE UNIVERSITY OF NEWCASTLE AUSTRALIA

ARCHITECT: architectus

SCALE: 1:100 @ A0

PROJECT: THE UNIVERSITY OF NEWCASTLE CITY CAMPUS STUDENT ACCOMMODATION 20 CIVIC LANE NEWCASTLE NSW 2300

DRAWING TITLE: STORMWATER MANAGEMENT PLAN

JOB NUMBER: 242432

DRAWING NUMBER: DA-C06.01

REVISION: A

NOT FOR CONSTRUCTION

