

A NeW Space for the city



THE UNIVERSITY OF
NEWCASTLE
AUSTRALIA

THE UNIVERSITY OF NEWCASTLE PROPOSES TO DELIVER WORLD CLASS STUDENT EXPERIENCE THROUGH THE DEVELOPMENT OF A NEW CITY EDUCATION PRECINCT IN THE CBD OF NEWCASTLE.

NeW Space is a \$95 million landmark education precinct being developed by the University of Newcastle in the Newcastle CBD. The precinct will deliver a technology focused learning institution providing a world-class experience for students and will host a range of University-supported activities including:

- Business and Law programs
- Social learning spaces
- Digital library services and information commons
- Collaborative learning and research spaces
- Work integrated learning
- Facilities for engagement with industry, business and the community

A minor refurbishment to University House will also be undertaken as part of the project in order to integrate University House with the new building.



A CAMPUS DESIGNED FOR THE FUTURE

The NeW Space project is an exceptional opportunity to create a campus that will be a catalyst for remaking both the physical and cultural heart of the city of Newcastle.

As part of the brief for the architects in designing a city campus, the university wanted a space that would provide engagement opportunities and enhance connectivity for the community, not just with our building, but with the surrounding buildings and open spaces.

The brief required placing students at the centre of the design; creating a space where they will want to spend time in academically and socially. It needed to create spaces where students and academics can meet and engage in a variety of formal and informal ways as well as areas for quiet reflective learning.



INVESTMENT

NeW Space is jointly funded by the Australian Government through the Education Investment Fund, the New South Wales State Government through the Hunter Infrastructure and Investment Fund and the University of Newcastle.

The \$95 million funding envelope comprises 3 aspects:

- \$30 million from the Commonwealth Education Investment Fund
- \$25 million from the NSW State Government administered by the Hunter Development Corporation
- \$40 million committed by the University of Newcastle demonstrating the Universities commitment

WHY BUILD A NEW CAMPUS

There is already a step change in the tertiary education sector's approach to teaching and learning and this new direction will enhance the skills of our graduates to better prepare them for a challenging regional, national and global labour market.

These new changes in teaching philosophies and studying styles are driving dramatic changes in the physical environments in which students learn and engage in all aspects of their university experience.

The University of Newcastle aspires to be a leader in this field and the NeW Space project is an opportunity for the university to accelerate this innovation in higher education.

Creating a campus design tailored specifically to embrace these new trends and to optimise the impact of technology enabled learning, is a strategically sound response to the need of providing innovative education.

The expectations of our students and staff are changing. The spaces we are creating within the building design will support the university's new direction in the way we deliver our Business and Law courses.

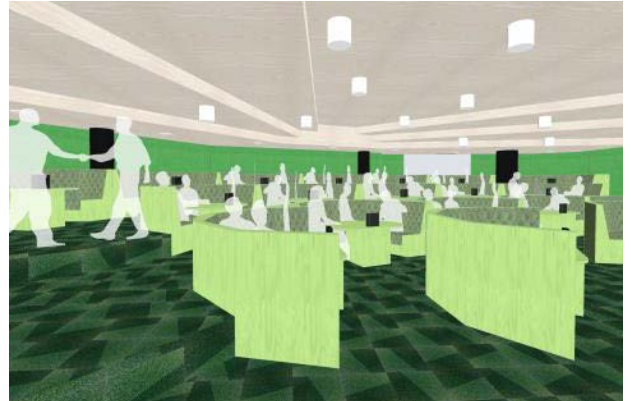

A BRIEF SUMMARY OF THE STATE SIGNIFICANT DEVELOPMENT APPLICATION PROCESS

The NeW Space project is being assessed as a State Significant Development (SSD) by the Department of Planning and Environment pursuant to Part 4 of the *Environmental Planning and Assessment Act (1979)*.

The University has commissioned a number of specialist reports in developing its application for the NeW Space project. The application and associated reports can be found on the NSW Department of Planning and Environment website at www.majorprojects.planning.nsw.gov.au.

As part of the department's review of the application, the plans are on public exhibition and the community are invited to comment by making a written submission to the department. Once the exhibition period has closed, the University is given the opportunity to address issues raised in the submissions.

A report by the department is then provided to the NSW Minister for Planning for their determination on the project.

More information on the SSD process can be found at www.planning.nsw.gov.au

For more information about the project, visit us at:

www.newcastle.edu.au/newspace

Email us at:

newcastle@newcastle.edu.au

